



**Corfe Mullen  
Dorset, BH21 3PH**

# Corfe Mullen, Dorset, BH21 3PH

## FREEHOLD PRICE: £450,000

A deceptively spacious three double bedroom, two reception room, two bathroom detached bungalow with mature, private garden set in a quiet cul-de-sac location and within easy reach of local amenities. First time to the market in 50 years!

- Generous size entrance hall with good storage and loft access
- Kitchen with range of matt cream units and complementary worktops, four ring gas hob, electric cooker, space for free standing dishwasher and fridge and side access to garden
- Separate utility room with plumbing for washing machine, a range of units with complementary worktop, sink and space for fridge freezer
- Generous 'L' shaped sitting/dining room with feature wall with gas point, large picture window overlooking garden, double-glazed sliding patio doors opening onto garden and access to bedroom three/study
- Three double bedrooms, the main bedroom has fitted wardrobes and en suite shower room with walk in shower, wash hand basin set in a vanity room and low level flush WC. Bedroom three is set at the rear of the property and is currently used as a large study
- Family wet room style shower room with walk in shower large enough for wheelchair access, pedestal wash hand basin and low level flush WC
- Outside: Mature rear garden laid to lawn with summerhouse
- Garage with power and light, off road parking for two cars

The property is situated in a well established area in a popular location which is close to highly sought after schools as well as a range of shops and amenities. It is approximately three miles from Wimborne town centre where a number of shops, restaurants, public houses can be found as well as the renowned Tivoli theatre.

COUNCIL TAX BAND: E      EPC RATING: D

AGENTS NOTES: The heating system, mains and appliances have not been tested by Hearnese Estate Agents. Any areas, measurements or distances are approximate. The text, photographs and plans are for guidance only and are not necessarily comprehensive. Whilst reasonable endeavours have been made to ensure that the information in our sales particulars are as accurate as possible, this information has been provided for us by the seller and is not guaranteed. Any intending buyer should not rely on the information we have supplied and should satisfy themselves by inspection, searches, enquiries and survey as to the correctness of each statement before making a financial or legal commitment. We have not checked the legal documentation to verify the legal status, including the leased term and ground rent and escalation of ground rent of the property (where applicable). A buyer must not rely upon the information provided until it has been verified by their own solicitors.





# Ground Floor

Approx. 117.9 sq. metres (1269.4 sq. feet)

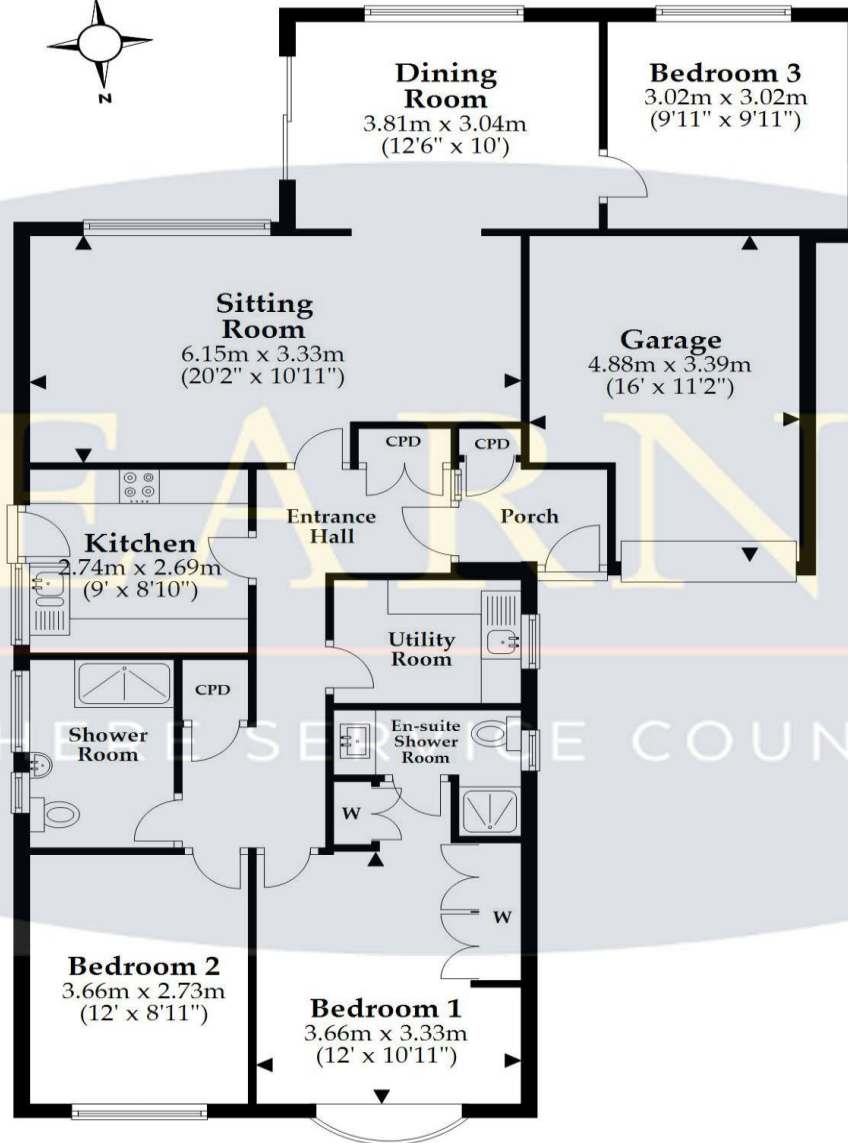

Total area: approx. 117.9 sq. metres (1269.4 sq. feet)

This plan is not to scale and it is for general guidance only. LJT Surveying Ltd Ringwood







**HEARNES**

WHERE SERVICE COUNTS

[www.hearnes.com](http://www.hearnes.com)

6 Cook Row, Wimborne, Dorset BH21 1LB

Tel: 01202 842922 Email: [Wimborne@hearnes.com](mailto:Wimborne@hearnes.com)

OFFICES ALSO AT: BOURNEMOUTH, FERNDOWN, POOLE & RINGWOOD