



**HEARNES**  
WHERE SERVICE COUNTS

# Ringwood, Hampshire, BH24 1SL

## FREEHOLD

**A beautiful private and landscaped garden, plenty of parking and extremely spacious accommodation, are just a few features of this outstanding, detached chalet style property that has been extensively and thoughtfully remodelled approximately nine years ago to create a bright, spacious and flexible family home.**

Positioned within a short walk to all the facilities in Ringwood Town Centre and the local schools, this property is the perfect family home.

The ground floor has two useful double bedrooms, both serviced by a contemporary family bathroom. A spacious living room with aspect into the garden and the 'hub of the home' - a delightful open plan kitchen, with ample room to enjoy social gatherings and a fantastic arrangement of modern floor and wall mounted units and Quartz worktops.

The remaining ground floor comprises of an integral garage with utility area and a modern glass and steel framed staircase to the first floor.

The first floor lies host to three further double bedrooms. All with en-suite facilities and fitted wardrobes.

The garden is a particular feature of the property, having been landscaped to create a beautiful garden space laid to gravel and AstroTurf for low maintenance living. From the rear patio doors, you walk out to a full width paved area which leads onto the lawn areas with curved raised beds ideal also for seating. A summerhouse is well placed to enjoy the summer weather and could be utilised as a home office.

The front offers plenty of parking and turning space with access to the garage and covered front entrance porch.

**COUNCIL TAX BAND: F New Forest**

**ENERGY PERFORMANCE CERTIFICATE RATING: C**

AGENTS NOTE: The heating system, mains and appliances have not been tested by Hearn's Estate Agents. Any areas, measurements or distances are approximate. The text, photographs and plans are for guidance only and are not necessarily comprehensive.





## Ground Floor

Approx. 122.5 sq. metres (1318.4 sq. feet)

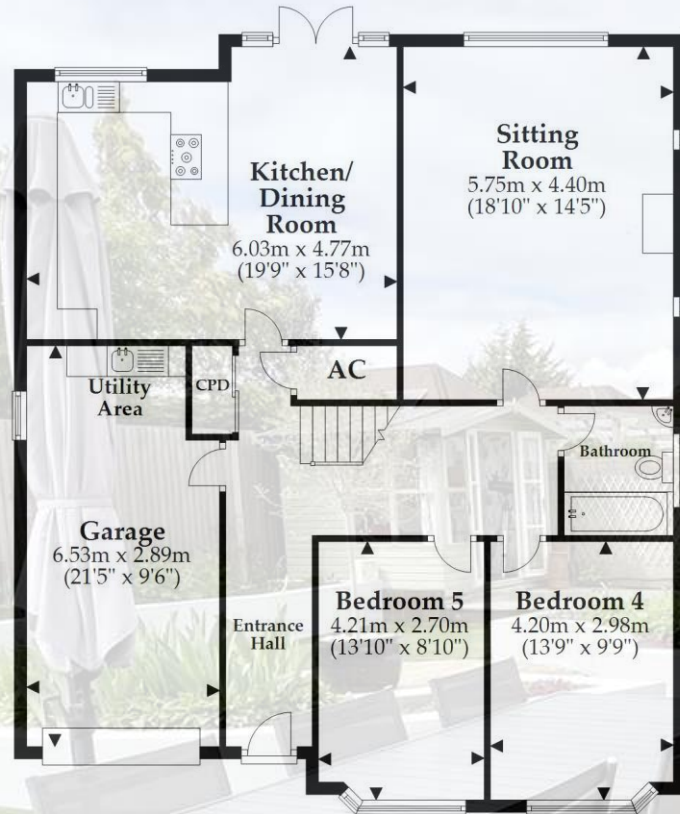

## First Floor

Approx. 72.2 sq. metres (777.3 sq. feet)



## Summerhouse

Approx. 5.5 sq. metres (58.7 sq. feet)

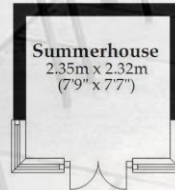

Total area: approx. 200.2 sq. metres (2154.4 sq. feet)

This plan is not to scale and it is for general guidance only. LJT Surveying Ltd Ringwood







[www.hearnes.com](http://www.hearnes.com)

52-54 High Street, Ringwood, Hampshire, BH24 1AG

Tel: 01425 489955 Email: [ringwood@hearnes.com](mailto:ringwood@hearnes.com)

OFFICES ALSO AT: BOURNEMOUTH, FERNDOWN, POOLE & WIMBORNE