



HEARNES
WHERE SERVICE COUNTS

White Lion Courtyard, Ringwood, Hampshire, BH24 1AJ

LEASEHOLD

This charming two bedroom top floor apartment is accessed via secure intercom and stairs / lift available to all floors. This lovely apartment is one of just two on this level and the lift stops right alongside the front door.

The generous entrance hallway gives access to all rooms with a sizeable living room having attractive beamed and vaulted ceiling and access to the well placed and modernised kitchen, having a comprehensive range of units including built in oven and hob. The two double bedrooms are generous in size and both with fitted cupboards one having a walk in wardrobe/ storage cupboard. The family bathroom is well placed to service both rooms and offers a modern suite with corner shower, low level wc and vanity wash hand basin.

The property offers well kept communal grounds as well as a residents lounge and plenty of residents events throughout the year.

This exclusive well maintained development is aimed strictly for the over 55's and is ideally located for the town centre.

Lease Information

Approximately 65 years remaining - flexibility on the asking price will be considered to renew the lease.

Approximate service charge: £2383

Approximate Ground Rent: £664

COUNCIL TAX BAND: D

ENERGY PERFORMANCE RATING: C

AGENTS NOTE: The heating system, mains and appliances have not been tested by Hearn's Estate Agents. Any areas, measurements or distances are approximate. The text, photographs and plans are for guidance only and are not necessarily comprehensive.

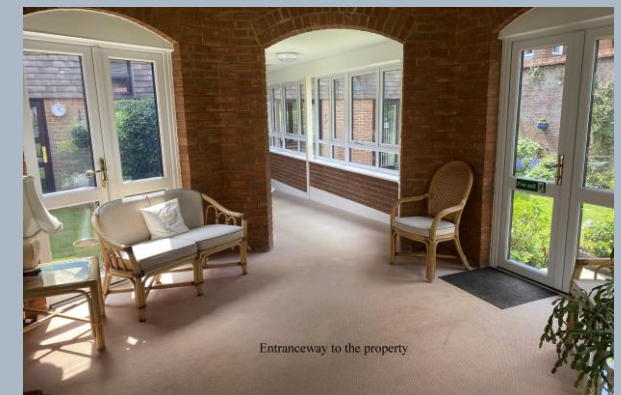

Top Floor

Note; Measurements were not taken by LJT Surveying and we cannot guarantee their accuracy.

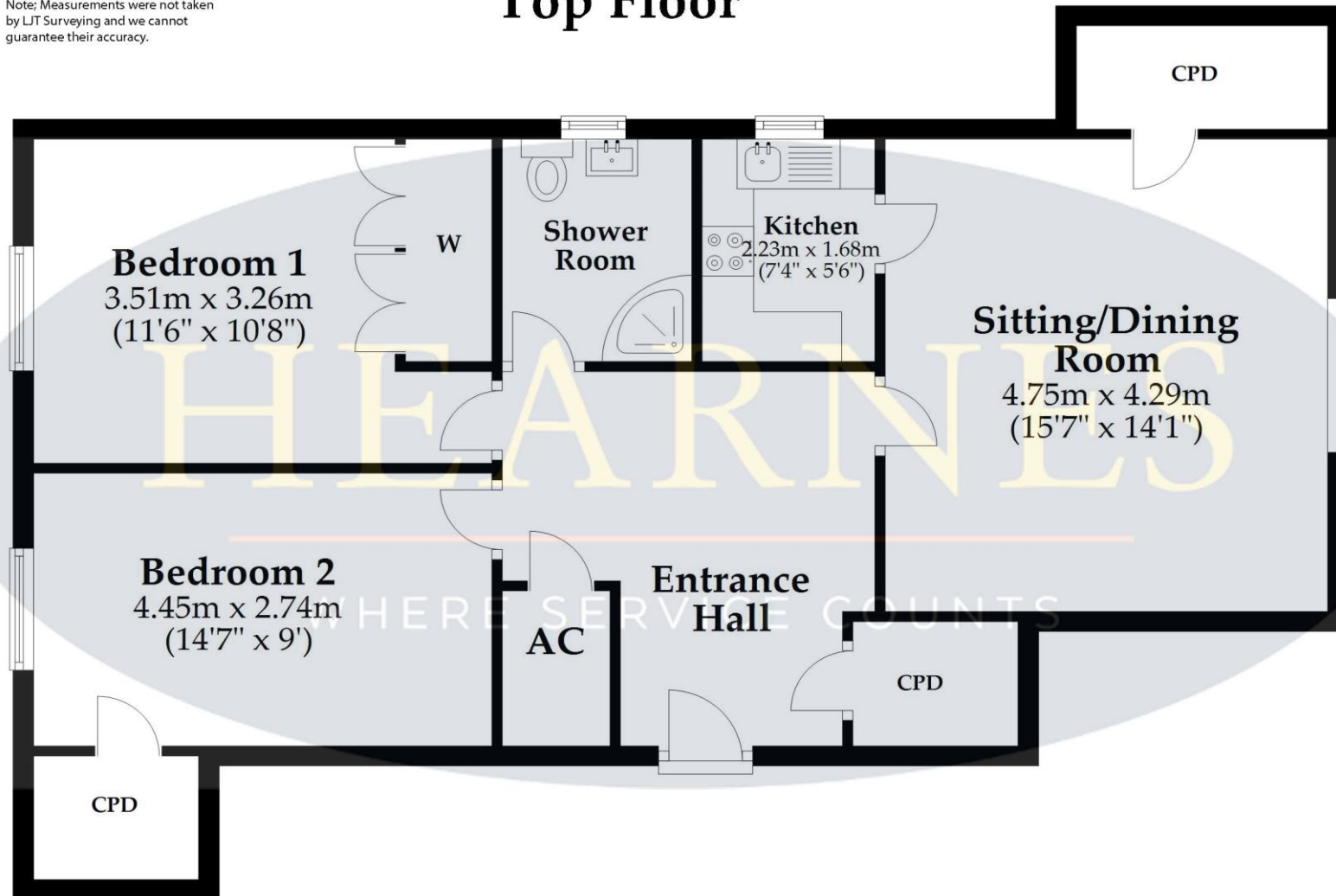

Total Floor Area: approx. 79.7 sq. metres (858 sq. feet)

This plan is not to scale and it is for general guidance only. LJT Surveying Ltd Ringwood



52-54 High Street, Ringwood, Hampshire, BH24 1AG Tel: 01425 489955 Email: ringwood@hearnes.com www.hearnes.com

OFFICES ALSO AT: BOURNEMOUTH, FERNDOWN, POOLE & WIMBORNE

