



HEARNES
WHERE SERVICE COUNTS

Ashley Heath, Ringwood, Hampshire, Bh24 2HB

FREEHOLD

An incredibly popular location close to the Castleman Trailway, extensive parking and a detached double garage, are just a few features of this delightful, detached bungalow that is being offered with no chain.

This charming property has been well maintained but still offers fantastic potential to further improve or extend (stpp) and sits on a mature corner plot of approximately 0.3 acres.

Inside is well planned accommodation with the bedrooms being at one end of the property, whilst the living space is at the other. It comprises three generous double bedrooms, all benefitting from built-in wardrobes. The master has a private en-suite shower room while the remaining bedrooms share a modern white family bathroom.

The bright and spacious sitting room and dining room enjoy a dual aspect and are split-level which is a nice feature. A door from the dining area leads to a comprehensively fitted kitchen with useful adjoining conservatory/utility porch.

This fine home also benefits from gas central heating, double glazing and a separate cloakroom.

The rear garden is private and enclosed, being mainly laid to lawn with established hedges and shrubs. Located in one corner is a fantastic timber garden room (installed 2020) with power and light. This incredibly useful outside room would make an excellent gym/office or additional occasional accommodation.

The remainder of the grounds are open plan with mature ground covering shrubs and established trees. The driveway provides plenty of parking and leads to the detached double garage.

COUNCIL TAX BAND: F

ENERGY PERFORMANCE RATING: D

AGENTS NOTE: The heating system, mains and appliances have not been tested by Hearnes Estate Agents. Any areas, measurements or distances are approximate. The text, photographs and plans are for guidance only and are not necessarily comprehensive.

Note; Measurements were not taken by LJT Surveying and we cannot guarantee their accuracy.

Ground Floor

Approx. 124.6 sq. metres (1341.5 sq. feet)

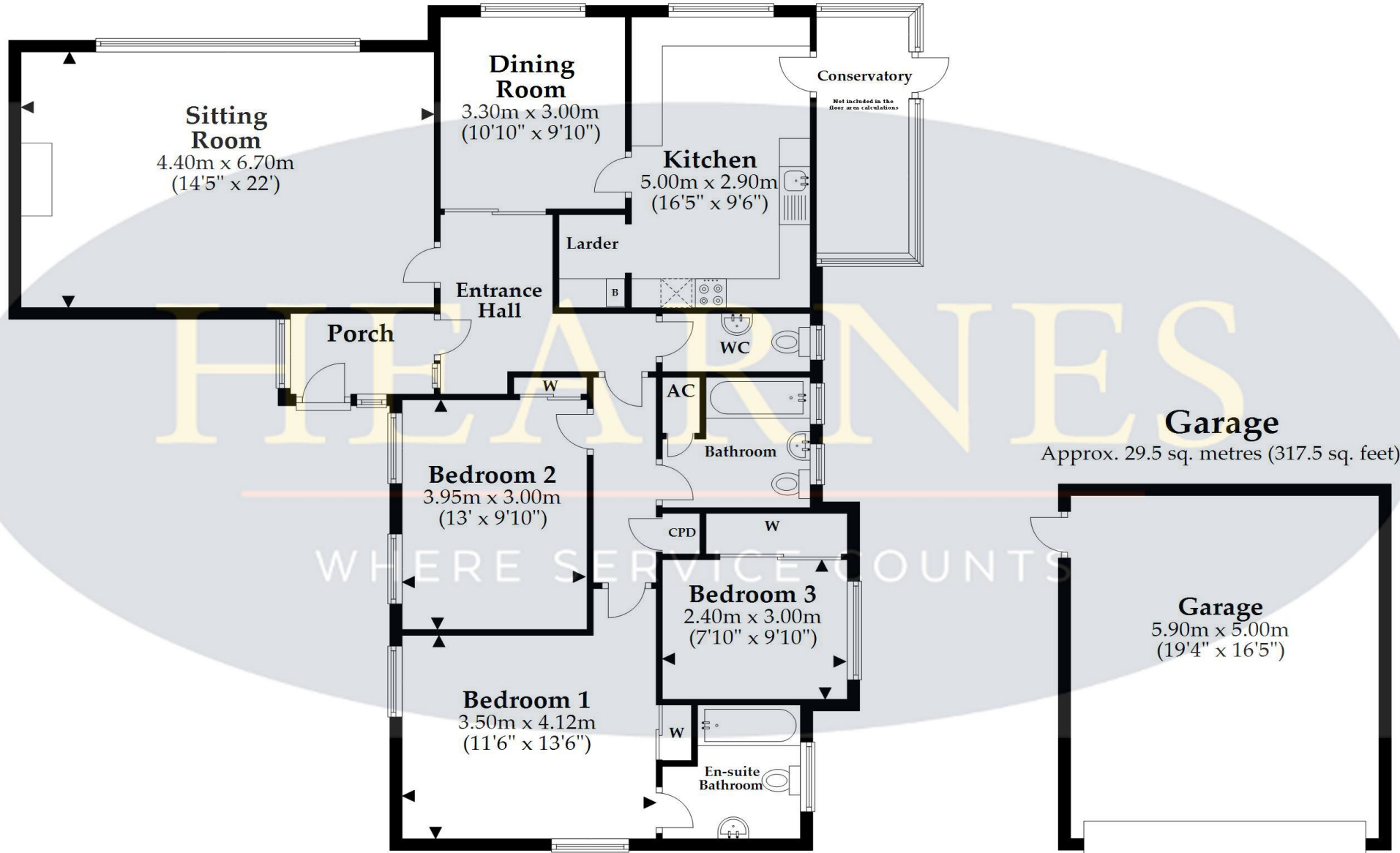

Total area: approx. 154.1 sq. metres (1659.1 sq. feet)

This plan is not to scale and it is for general guidance only. LJT Surveying Ringwood



52-54 High Street, Ringwood, Hampshire, BH24 1AG Tel: 01425 489955 Email: ringwood@hearnes.com www.hearnes.com

OFFICES ALSO AT: BOURNEMOUTH, FERNDOWN, POOLE & WIMBORNE

